

# TOTEM



TORRENT   
TECHNOLOGY

ELEMENT SERIES USER MANUAL

Made in Canada 



DESIGN ADVANTAGES: THE TORRENT WOOFER CAN MAINTAIN A SIGNIFICANT OUTPUT LEVEL UP TO 5KHZ AND REMARKABLY DOESN'T REQUIRE BEING CROSSED OVER. THE AMPLIFIER CAN MAKE A DIRECT CONNECTION TO THE WOOFER WHICH BYPASSES ANY DISTORTION AND INEFFICIENCY INTRODUCED BY THE CROSSOVER AND ALLOWS THE AMPLIFIER TO DIRECTLY CONTROL THE EXCURSION OF THE DRIVER. IT IS THE ULTIMATE IN DRIVER ENGINEERING AND OFFERS A PANORAMIC, NON-DIRECTIONAL DISTRIBUTION OF SOUND WITH OPTIMAL COHERENCE AND PHASE ACCURACY IN ALL FREQUENCIES. IN OTHER WORDS, THE PUREST EXPRESSION OF TOTEM DNA.



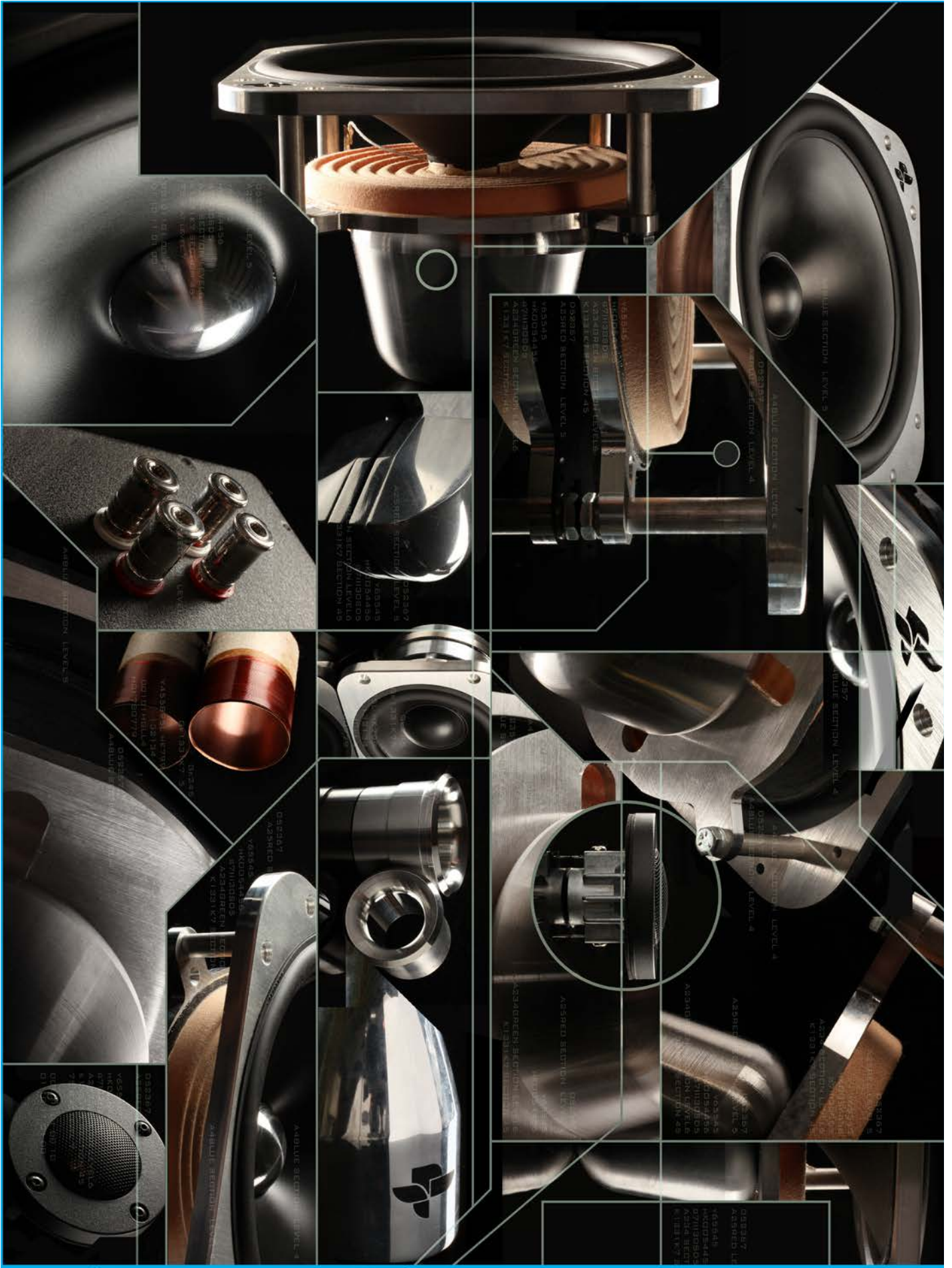

# ELEMENT SERIES



We must admit that we believe that this new generation is incomparable in musical and technical performance to all that is out there in the market. Aesthetically it differentiates itself externally via new all 'black look' anodized Torrent woofers and equally black anodized Claw and Skid Plate. The new V2 transducers are a dramatic advancement and a serious transformation of the famous 7-inch Torrent.

Evolved and meticulously developed during these last 10 years at Totem, they are at the top of the world's dynamic speaker pyramid. Remember that the Torrent system remains exclusive to Totem, developed here in Quebec with knowledge and pride!



# CONGRATULATIONS

We sincerely thank you for having granted Totem the special place in your living environment. These speakers are designed to redefine your musical understanding and open corridors of new experiences. We hope you not only enjoy but experience Totem as your guide to a new and rewarding listening environment! You will without a doubt experience a Totem moment.

## OUR VISION

Created in 1987, Totem's mission is to develop loudspeakers capable of producing an involving performance that is true to the artist's intention. Our goal is to provide designs that are affordable, cosmetically timeless, and invoke an emotional response. Music, movies, TV, and video games are accurately rendered with a powerful focus that is yet soul stirring. Discover yours today.

Each speaker is a 'piece de resistance' that attests to the profound sound staging that can be reproduced by adaptable and innovative engineering. Listen and believe...

## USER MANUAL

Please take the time to fully read this manual prior to beginning set-up. The manual will clearly guide you to achieve the best possible sound that these newly acquired Totem speakers can provide.

## UNPACKING

Totem Acoustic keeps to a strict quality control regimen and all factory-sealed products leave our facility in perfect condition. If there are any damages visible or concealed that has occurred in handling it must be reported immediately to your Authorized Totem Dealer.

Carefully remove the speaker(s) from the box(es); take caution as the size often defies the actual weight. Save all custom cartons and packaging foam for future use.



## Acoustic & Aesthetic Objectives

- Enormous sound and powerful bass from a smaller cabinet that can be conveniently integrated into any room. These are often considered mutually exclusive characteristics.
- Meticulously crafted for peak performance that lasts decades. Designed obsolescence is rampant in consumer electronics, we favour longevity.
- Aesthetics must be timeless and not trendy. Totem speakers never go out of style.

## TOTEM Speaker Design Characteristics

- Proprietary scientific formulas are the foundation for the essence of Totem, eschewing outdated design guidelines and parameters.
- Customized drivers, each quite unique and either manufactured by us or built to our exacting specs.
- Hand made crossovers composed of the most exotic components and meticulously assembled.
- Artisanal cabinet construction, including lock mitred assembly, interior and external veneers, Borosilicate in some cases, and

## TOTEM Sonic Signature

- Holographic imaging for a three-dimensional, expansive soundstage.
- Bass impact that is forceful and logic defying, considering the conveniently sized enclosure.
- Most importantly, the linear phase response for uncanny, almost magical realism.

All Totem drivers are custom engineered but the best example of Totem's unique approach to driver design is the Torrent woofer, found in the Element series and select models of the Tribe series.

The genesis for the Torrent's revolutionary application was our conviction that a driver could be made without using any active or passive crossover parts in the signal path of the woofer section. All speakers with Torrent drivers only have a simple crossover composed of as little as two components exclusively for the high frequency section. A crossover free network in the woofer path allows the purest flow of sound and energy. Torrent displays remarkable control and striking accuracy both on and off axis while projecting unsurpassed clarity and phase correctness for an immersive and gripping musical experience.



This platform uses a compound magnet system of unique geometry, deploying multiple 2.5" long neodymium magnets to completely encircle the voice coil. These magnets have a geometrical claw shape to further optimize magnetic efficiency and directionality. The creates an extraordinarily high magnetic flux throughout its enormous 1" throw so it accelerates blazingly fast and brakes instantly. It is a new level of speed and power, consider it the Ferrari of woofers.

The framework and motor structure of the 7" Torrent is micro-machined and hand assembled from over 30 pounds of aircraft grade aluminum, stainless steel and other alloys. The artisanal craftsmanship and is more akin to the manufacturing process of a fine watch or racing engine, taking over 10 labor intensive hours to meticulously assemble. The finished driver weighs just under a staggering 10 pounds.

The ultimate goal of Torrent was to achieve musical purity coupled with prodigious power. The crossover-less design means the amplifier makes a direct connection to the woofer, bypassing distortion and coloration introduced by a crossover. The magnetic structure bestows a controlled fury of bass energy that is at once both explosive and tuneful. In other words, Torrent is the purest expression of Totem DNA.

# ELEMENT SERIES



## SPEAKER POSITIONING AND PLACEMENT

Totem Element Series produce great dispersion, both on the vertical and horizontal axis. They can be placed in extremely varied positions and still produce a large and accommodating, non-shifting soundstage. Keep in mind that a room with a variety of materials will deliver a much more harmonized sound. These speakers are of a superior design and will perform remarkably well in a variety of spaces. Particular care should be taken to ensure proper placement. Below are some guidelines for general in-room placement that can help optimize performance.

## FIRE V2 MONITOR

The Fire V2 monitor should be placed on appropriate stands, or shelves, so the tweeter is roughly ear level. Depending on the seated position and height, we generally recommend stands 18"-24" tall.

If the stands offer the option of being filled, we recommend you do so. This improves stability and ensures a more accurate bass response. Spikes or cones at the base, as well as a soft absorption material between the speaker and top plate of the stand improve isolation and performance as well.

## FIRE V2 AND METAL V2

Element series speakers create a three-dimensional, accurate soundstage without requiring any toe-in. If the distance between them is greater than 8 feet (2.5 m) and the room acoustics are having a substantial effect to the imaging, then you can experiment with angling them. Start by toeing-in one speaker slightly and then the other, if needed. Gradual experimentation is the key.



## FIRE V2 AND METAL V2

Totem generally recommends that speakers be positioned 12 in (30.5 cm) from the back wall and side wall to allow a better energy flow and cleaner bass response. Moving them closer to boundaries will result in more bass enhancement but can negatively affect the perceived depth of the soundstage. Moving them farther will result in less bass reinforcement. Placing them anywhere from 4-10 feet (120-300 cm) apart will generally ensure a proper stereo image. A popular guideline is for the listening position distance to be 1.5 times the space between the speakers, so if speakers are 6 feet (180cms) apart you would be 9 feet (270cms) from them. But, all rooms and listening positions are different, so we encourage you to experiment with finding their final ultimate resting spot. We are confident you will thoroughly enjoy them whether they are placed on stands, in a bookshelf, on furniture, wall mounted, and anywhere else you want them. More information can be found on the Support page of our website. [www.totemacoustic.com](http://www.totemacoustic.com)

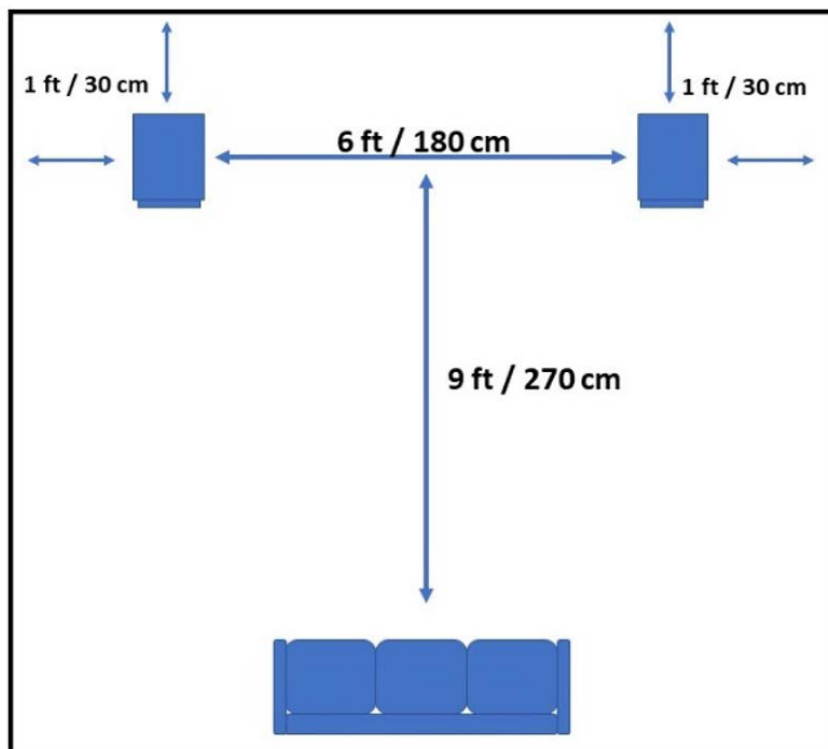



## SURROUND SOUND PLACEMENT GUIDELINES

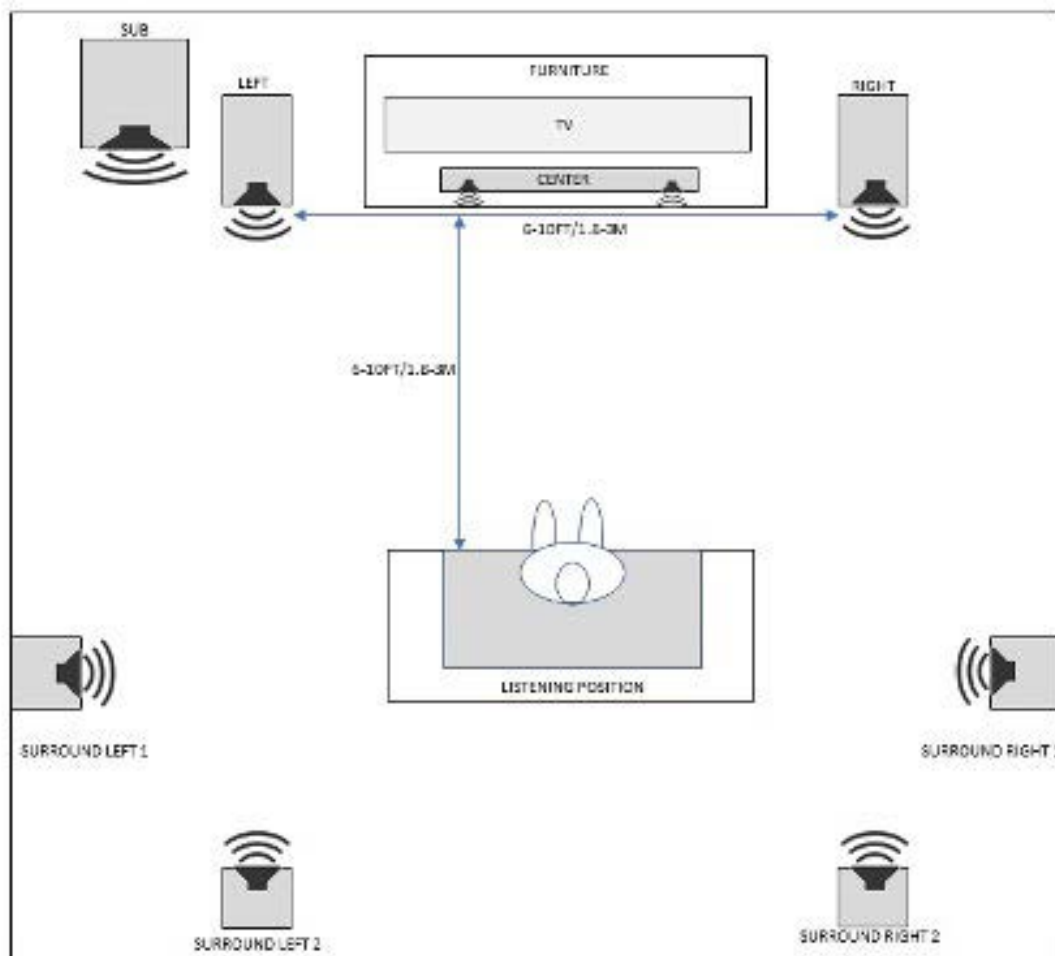

Whether surround or stereo, the placement guidelines for the front two channels are the same. Here are some suggestions for the additional channels used home theater set ups.

## SURROUND SOUND PLACEMENT GUIDELINES



Whether surround or stereo, the placement guidelines for the front two channels are the same. Here are some suggestions for the additional channels used home theater set ups.

Surround speakers are generally placed behind and adjacent to the listening area, at a height of approximately 6 feet. In 7.1 systems, they are also located behind the listening position.



Center Channel Speakers are designed for dialog and main action to emanate from come from the video screen. The speakers should therefore be centered to the screen, 20-30 in (50.8 - 76.2 cm) above the floor, preferably equidistant from the main speakers. The Wood V2 is carefully voiced to seamlessly match the Fire v2 and metal V2.



Subwoofers can be placed virtually anywhere but closer to corners can enhance their bass output.

The key to maximizing their performance is experimentation. These suggestions are good guidelines to start but you might find that slight tweaks of their position could provide substantially better performance.

More information can be found on the Support page of our website. [www.totemacoustic.com](http://www.totemacoustic.com)

# ELEMENT SERIES



## ARTICULATED CLAW AND SKID PLATE DECOUPLING SYSTEM



The Metals have predrilled holes in the base of the speaker to facilitate the installation of the articulating claw and skid plate. No tools are required, a key that fits the hardware is included. Start by positioning the speaker on the top portion of the cabinet. Take precaution to protect the lustrous finish by using the packaging foam end cap to secure your speaker prior to installation of these parts.

Included with Element Metal

This unique decoupling system consists of two components; the articulating claw which creates a rake, and the skid plate.

This unique claw can be adjusted to modify the angle of the cabinet rake to allow optimal bass loading and phase/space articulation. The aluminum plate including two integrated, formed feet at the base of the speaker, effectively eliminates resonances between the floor and speaker enclosure. Together, they perfect the phase linearity and allows the speaker to take full advantage of its bass and soundstage capability.



**Element Metal includes both black rubber and metal bearings. Either can be used.**

## ARTICULATED CLAW AND SKID PLATE DECOUPLING SYSTEM



The Articulating claw consists of two pieces; the claw itself and a threaded insert. The threaded insert fits into the base of the claw and can be adjusted as desired.

Insert a screw into the articulating Claw and position it over the pre-drilled hole; the screw will serve as a guide to find the pre-drilled hole. Carefully tighten it while firmly pushing the claw flush against the front speaker surface, making full contact with the surfaces. Repeat the procedure for the skid plate. Insert the self-centering ball bearing underneath the claw and feet of the skid plate. The decoupling system can be used with or without the ball bearings, depending on the floor surface.

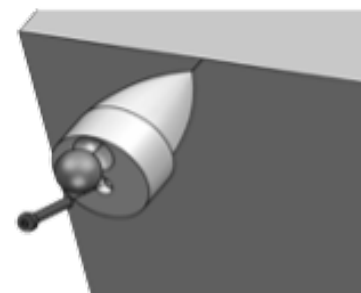

**NOTE: CLAW AND SKID PLATE ARE BLACK. SILVER IS DISPLAYED HERE FOR GREATER CONTRAST AND CLARITY.**

# ELEMENT SERIES



## CONNECTORS

All connections should be made with the equipment turned off.



World Renowned  
W.B.T. PLATINUM  
CONNECTORS

Element Series speakers feature Platinum WBT Bi-Wire / Bi-Amp Connectors in an Annealed Aluminum Plate. They are the ultimate connectors, with the highest conductivity, and are fitted onto an annealed aluminum plate to eliminate any potential resonance. The combination prevents any signal loss and help get the most out of the entire system.

binding post terminals that accommodate 5 methods of connection: bare wire wrapped around the post, wire through the hole of the post, pin connectors through the posts, banana plugs, and spade lugs. A spade lug size of 8.1mm / 5/16" to 9 mm / 3/8" is required for proper fit. We recommend the WBT 0681 spade for its quality and fit but any spade in the size range can be used.

The Metals have predrilled holes in the base of the speaker to facilitate the installation of the articulating claw and skid plate. No tools are required, a key that fits the hardware is included. Start by positioning the speaker on the top portion of the cabinet. Take precaution to protect the lustrous finish by using the packaging foam end cap to secure your speaker prior to installation of these parts.

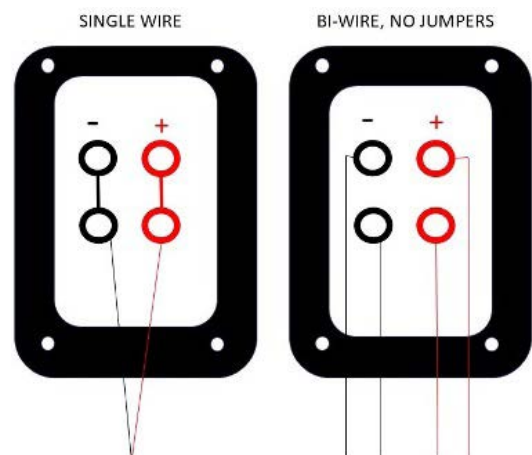

## AMPLIFIER DISTORTION

The most common source of speaker damage results from amplifier distortion. Your amplifier may run out of clean power upon listening at loud levels. A direct consequence of such an overuse is distorted power, producing a greater quantity of distortion than its rated output power. This provides a threat of damage to any loudspeaker.

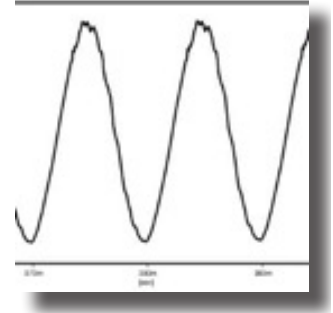

The greater the amplifier power, the safer the loudness potential. A 50 watt/channel amplifier, if driven above this 50 watt/channel limit, will naturally produce multiplicatively more distortion than at 50 watts. A 120 watt/channel amplifier will have substantial distortion above 120 watts but will not allow any significant distortion below 100 watts. To conclude, more amplifier power provides cleaner power and less possibility for damage.

## VOLUME

Volume controls on the amplifier/ receiver/preamplifier are very misleading. Please note that the volume control does not address power-output, but simply adjusts the audible level of music. It is the type of music being played that has an incidence on the amount of power used at a given volume level. Less dynamic music utilizes lesser amplifier power than more dynamic music does. With most music, the amplifier reaches its maximum power between the 11 and 1 o'clock position on the volume dial.

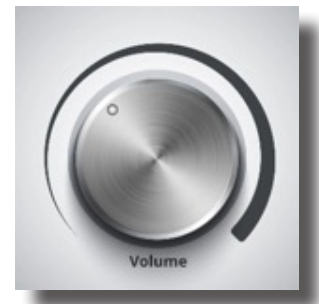

Distortion is inevitable when the amplifier is pushed above its rated output level, which may result in speaker damage. This occurs with any type of speaker. This type of damage constitutes abuse and may not be covered by warranty. Be attentive to the instant distortion commences, turning the volume control down to prevent speaker and/or amplifier damage.

Be wary of providing more power than is appropriate for your speakers and damaging them. Although a more powerful amplifier may provide better sound, it is very important to utilize speakers within their power-range rating to prevent damage.

# ELEMENT SERIES



## TROUBLESHOOTING

**No sound:** Verify that your pre-amp and/or amplifier, and receiver are plugged into the AC PLUG and are turned on. Verify that the wall AC outlet is functional and that your system is not on mute.

**Sound from one speaker only:** Verify the balance control on your system. Swap speaker sides to verify if speaker is functional. Verify power cords on all sources. (Amplifier, preamp, receiver, CD, DVR)

**Lack of bass or image:** Verify the polarity of speaker connections.

**Bass or no highs:** Check that the jumpers are in place between the terminals, or that all speaker wire is firmly connected.

## PERFORMANCE ENHANCING ACCESSORIES

### TRESS CABLE

**TRESS SPEAKER CABLES** A twisted pair of 14-gauge, multi strand, linearized oxygen-free silver-plated conductors coated in black and white Teflon. Dielectric shielding makes it impervious to damage and oxidization. Tress can be run long distances -in-wall and around room and are thin enough to be easily accommodated. It provides great extension in both high and low frequencies, excellent spatial ability, has no capacitance buildup, and is FT4 rated. It is one of the best performers out there, yet remarkably economical. Tress is also available in a bi-wire format, featuring a single stranded pair to a double stranded pair. These cables also include 12 WBT terminals.





## PERFORMANCE ENHANCING ACCESSORIES

### SINEW INTERCONNECT

The Sinew offers an unparalleled medium across which a signal can ride and pass through with no added coloration or loss of any kind.



### URTH POWER BLOCK



The ultimate power block, the URTH will lower the noise floor, smoothen the power, and satisfy the most demanding power requirements. Amplifiers, subs, cross overs or any audio component will benefit from URTH's quality components.

### URTH POWER CORD

When the AC flows freely and cleanly, and advanced isolation technology is used to thwart EMI/RFI, the rest of the chain clearly benefits. Urth Power Cord adds liveliness to the presentation and accents music in subtle but noticeable ways.



# ELEMENT SERIES



## SPECIFICATIONS

Totem Element Series speakers require between 200 and 300 hours of actual music playing time as a minimal break-in period. During this time, refrain from playing them at very loud levels. You will notice a definite gradual improvement in the cohesiveness of the music reproduction as this occurs.

Model	Wood V2	Fire V2	Metal V2
<b>Frequency Response +/-3dB:</b>	42 Hz - 22 kHz	30 Hz - 22 kHz	26 Hz - 22 kHz
<b>Recommended Power:</b>	50w-200w	50w-250w	50w-300w
<b>Woofers:</b>	2 x 6" Torrent	7" Torrent	2 x 7" Torrent drivers
<b>Tweeter:</b>	1" Titanium dome with 3/8" aluminum faceplate	1" Titanium dome with 3/8" aluminum faceplate	1" Titanium dome with 3/8" aluminum faceplate
<b>Impedance:</b>	6 ohms	8 ohms	4 ohms
<b>Sensitivity:</b>	92dB	88 dB	91 dB
<b>Dimensions (w x h x d) inches:</b>	27.5 x 7.5 x 10.75	8.81 x 16.6 x 11.7	11.7 x 43.5 x 14.9
<b>Dimensions (w x h x d) cms:</b>	69.85 x 19.05 x 27.31	22.38 x 42.16 x 29.72	29.8 x 110.49 x 37.85
<b>Placement from rear wall:</b>	6" to 5 feet	As little as 6", but varies based on electronics and room acoustics	As little as 6", but varies based on electronics and room acoustics
<b>Placement distance apart:</b>	N/A	As little as 2', but varies based on electronics and room acoustics	As little as 2', but varies based on electronics and room acoustics
<b>Break-in Time:</b>	200-300 hours	200-300 hours	200-300 hours
<b>Crossover Frequency:</b>	1st order on tweeter only	2nd order on tweeter only	3rd order on tweeter only
<b>Speaker Terminals:</b>	Bi-Wireable Platinum WBT	Bi-wireable, Platinum WBT connectors with Annealed aluminum plate	Bi-wireable, Platinum WBT connectors with Annealed aluminum plate
<b>Weight:</b>	10.43 kg, 22.94lb	14,74 kg, 32.4lb	33.34 kg, 73.34lb

## TOTEM LIMITED WARRANTY

All Totem products are created with the utmost care and quality in mind. If ever a problem should arise, Totem's Element series speakers are covered by a five (5) year limited warranty, starting from the date of purchase. The Totem limited warranty applies to products in normal home use only. The warranty is void if serial numbers have been altered or removed. The warranty is void if products show signs of abuse. The warranty is void if the speakers have been tampered with.

Speakers sold as 'demo' or 'floor models' from an authorized dealer have a limited warranty of 1-year parts and service from the date of purchase. Cosmetic issues or missing accessories are not covered by this limited warranty.

Please register online at <https://totemacoustic.com/register-your-product/> within two weeks of the purchase date. Product registration leads to quicker assistance and more efficient support in the rare case that your speaker should have a problem. The Totem speakers must be purchased from a TOTEM AUTHORIZED DEALER. Keep your original bill or receipt obtained from your Totem Authorized Dealer.

Retain the sturdy carton and all packing material; all warranty repairs are required to be shipped in their original packaging. This ensures no damage during transportation.

We reserve the right to any future change or modification without notice. If you have any further queries or require any classifications, feel free to contact your Totem Authorized Dealer.

Follow and Like us on Facebook. Instagram. Twitter  
<https://www.totemacoustic.com>



# TORRENT

TECHNOLOGY

---



Telephone: 866 222 1062 .  
totemacoustic.com

Totem Acoustic . 9165 Champ d'Eau . St. Leonard .  
Quebec. Canada . H1P 3M3

TOTEM   
*Discover yours*

